

Specifications

Extreme battery pack

- 12,000mAh Lithium-ion battery (44Wh)
- Bi-Directional USB-C input/output
- DC output (12V)
- USB output (5V 2A)
- 4 LED battery level indicator
- One-touch button technology
- Waterproof IP65
- Dimensions (L*H*W): 136 x 72 x 20mm
- 274g

Solar panel

- USB output (5V 1A)
- 5 Watt
- Clamshell design
- MPPT technology
- Opens to 210°
- Dimensions (L*H*W): 203x115x16mm
- 289g

POWERTRAVELLER INTERNATIONAL LTD

4 Delta Park,
Wilsom Road,
Alton
Hampshire, GU34 2QE
t +44 (0) 1420 542980

www.powertraveller.com

For customer support, email us at
support@powertraveller.com

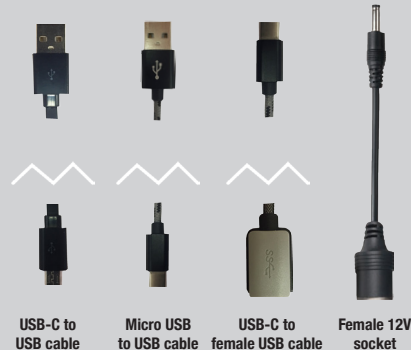
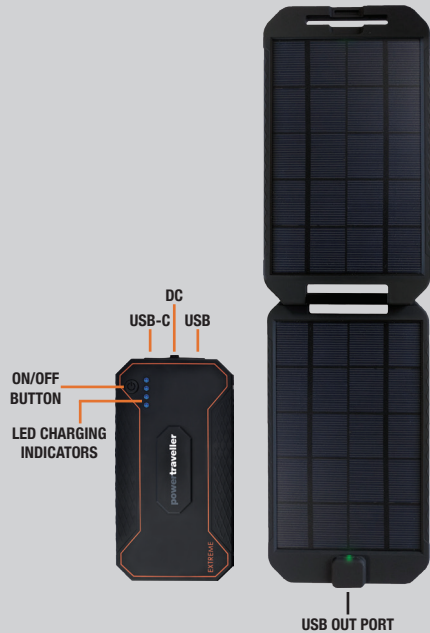

EXTREME WATERPROOF RUGGED SOLAR POWERED CHARGER USER GUIDE

YOU CAN: CHARGE SLR CAMERAS TABLETS
SMARTPHONES GOPROS GPS SAT PHONES
SMART WATCHES HEAD LAMPS AND MORE



Charging a device from extreme USB 2A output

To charge a 5V device, connect to the extreme's USB out port using the supplied USB cable or your device's own. The extreme will automatically turn on.

Charging a device from extreme DC 12V output

To charge 12V devices such as an SLR camera battery, hold down the on/off button for 3 seconds. Connect your device to the DC out port using the 12V female socket provided and an in-car charging cable (not supplied) to connect your device.

If you cannot find an appropriate in-car charger for your device, contact support@powertraveller.com for help.

Charging a device from extreme via USB-C

The USB-C port offers fast bi-directional charging so you can charge your USB-C/USB devices. Please note: The USB-C will NOT provide enough power for laptops.

Charging your extreme battery pack via USB-C

The extreme can be charged with the supplied USB-C cable from any USB port (laptop or USB plug adaptor). The extreme will automatically turn on.

Solar Panel

Place the solar panels in the sun for 30 seconds to 1 minute prior to charging. The solar panels should be outdoors and in direct sunlight for optimum charge.

Red light = power output low
Green light = power output high

Keep the panels clean by using a slightly damp cloth, no detergent.

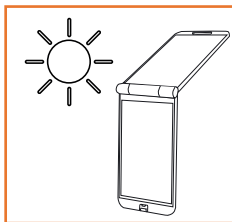

Adjust the panels as the sun moves

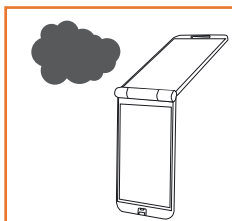

Overcast conditions will reduce efficiency

Charging your extreme battery pack via solar

To charge the extreme battery pack via the solar panel, connect using the USB to USB-C charging cable.

Turning the Extreme on

To turn the unit on, hold down the on/off button for 3 seconds. This will activate auto-on mode (for devices drawing low power). The lights will stay on while the unit is in permanent on mode. To deactivate, hold down the button for 3 seconds.

To check the level of charge left in the extreme when it is turned off, press the power button briefly. The blue LEDs will illuminate and the number of lights indicates the amount of charge remaining.

LED lights

Each illuminated light represents 25% of power. If the far left LED flashes blue, the extreme requires charging.

Daisy chain feature

The extreme can be daisy chained by using the USB-C cable via a USB port (laptop or USB plug adaptor) into the extreme unit. Any USB device can be charged at the same time.